



Ventouses Net®

Triple effet acoudé 3/8" (D1) - PA

ITEM 312

| RÉFÉRENCE | DESCRIPTION | Poids net | Volume (m ³) | Poids brut | Unités par lot |
|-----------|--|-----------|--------------------------|------------|----------------|
| 1017551 | VENTOUSE NET® 1/2" PA TRIPLE EFFET, COUDE 3/8" | 0,3033 | 0,02244 | 6,606 | 20 |
| 1017552 | VENTOUSE NET® 3/4" PA TRIPLE EFFET, COUDE 3/8" | 0,3539 | 0,02244 | 7,565 | 20 |
| 1017553 | VENTOUSE NET® 1" PA TRIPLE EFFET, COUDE 3/8" | 0,3611 | 0,02244 | 7,71 | 20 |



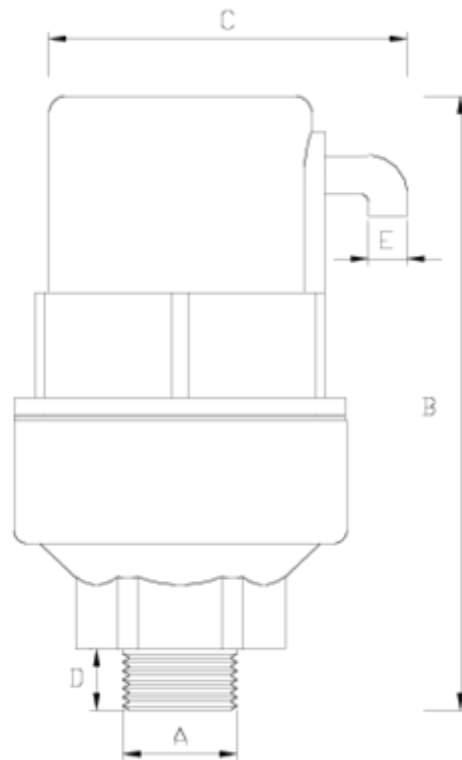

ITEM 312 | Triple effet acoudé 3/8" (D1) - PA

| Código | f A | Peso (g) | B | C | D | E | Material | PN | TIPO ROSCA |
|--------|------|----------|-----|----|----|------|----------|------|------------|
| 17051 | 1/2" | 296 | 137 | 78 | 14 | 1/8" | PPFV | PN16 | BSP |
| 17052 | 3/4" | 300 | 139 | 78 | 16 | 1/8" | PPFV | PN16 | BSP |
| 17053 | 1" | 307 | 142 | 78 | 19 | 1/8" | PPFV | PN16 | BSP |
| 17551 | 1/2" | 308 | 137 | 78 | 14 | 1/8" | PA | PN25 | BSP |
| 17552 | 3/4" | 312 | 139 | 78 | 16 | 1/8" | PA | PN25 | BSP |
| 17553 | 1" | 320 | 142 | 78 | 19 | 1/8" | PA | PN25 | BSP |





Documentation Produit



Certifications de produits

Certificats d'entreprise

